

# UNDERPLASTER PURENIT BOXES

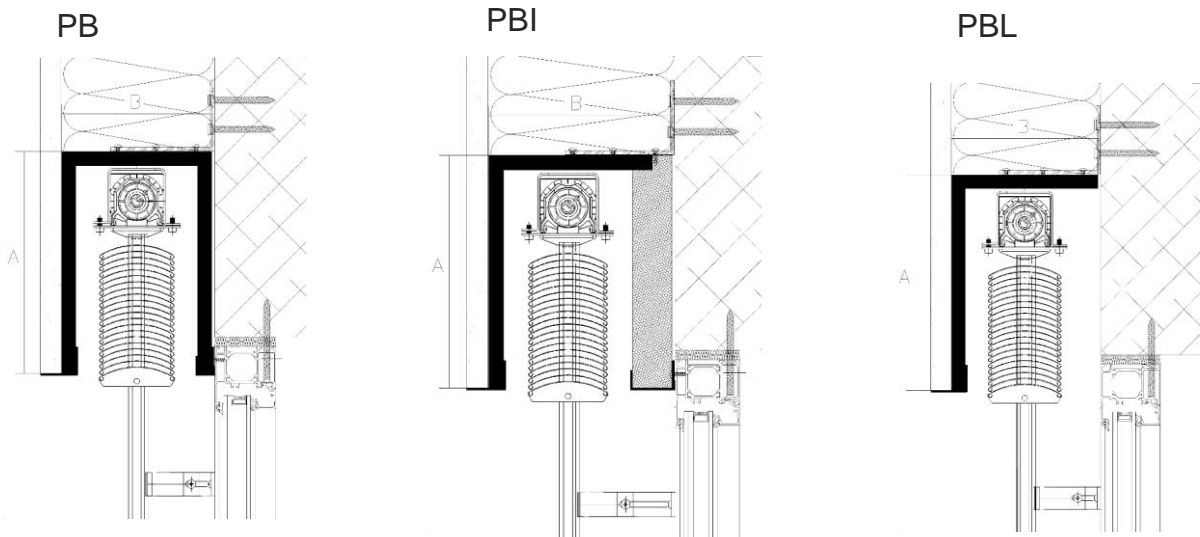

Underplaster rail

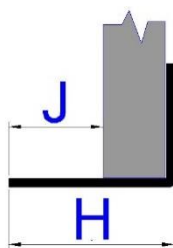

Dimensions		
Type	H	J
20	20	3
25	25	8
30	30	13
35	35	18
40	40	23
45	45	28

Mounting U profile

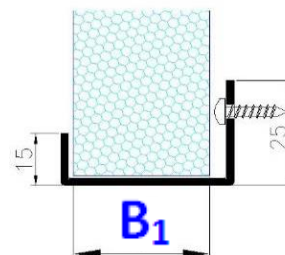

Type	B <sub>1</sub>
PB	15
PBI 30	30
PBI 40	40
PBI 50	50
PBI 60	60

## 1. BOX MEASURING

A – Outer height of front side of the box

B – Outer depth of the box  $B = 15 + E + B_1$

C – outer height of back side of the box (can be different from A)

D – outer width of the box (see pic. 2)

E – inner depth of the box (it is 130 mm for most types of blinds)

B<sub>1</sub> – thickness of PIR isolation

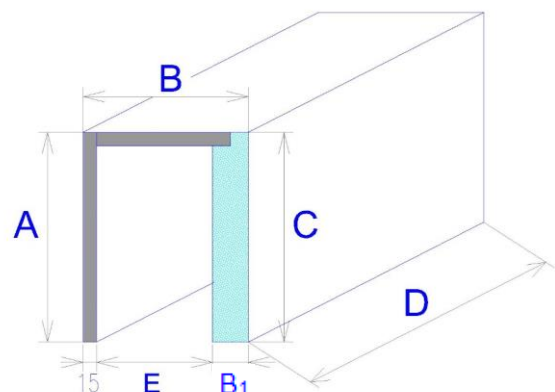

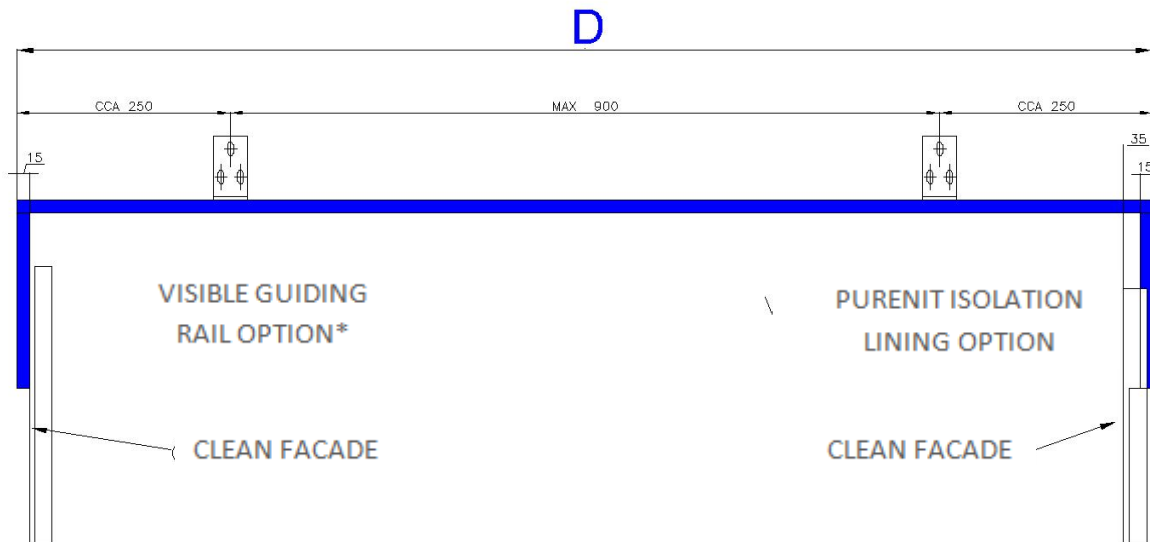
**LONGITUDINAL box cut** (recommended minimal number of brackets)

\* please order the side rail case and the rail together with the blind

Limit box dimensions				
Box length D		Dimension A	Dimension C	Dimension B
Min.	Max. in 1 piece*	Max.	Max.	Max.
450 mm	2400 mm	600 mm	600 mm	400 mm

**SETS OF BOXES AND CONNECTION OF BOXES**

PIf the box is longer than 2400mm (board size), it is supplied in two pieces split in the center. Connection of split boxes is made with connection set (connectors or squares). You can specify the splitting or box sets by yourself. In this case it is necessary to attach simple drawing **from the exterior** to the order form.

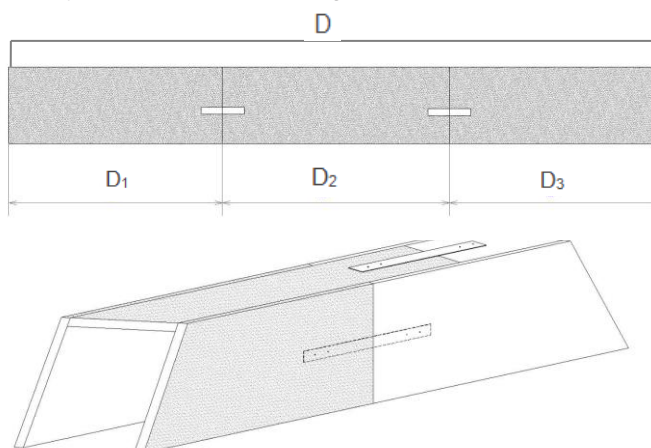

## CORNER SET

For corner set always measure outer sizes of the set and attach simple drawing to the order form. Corner set is supplied together with set of connectors and corners.

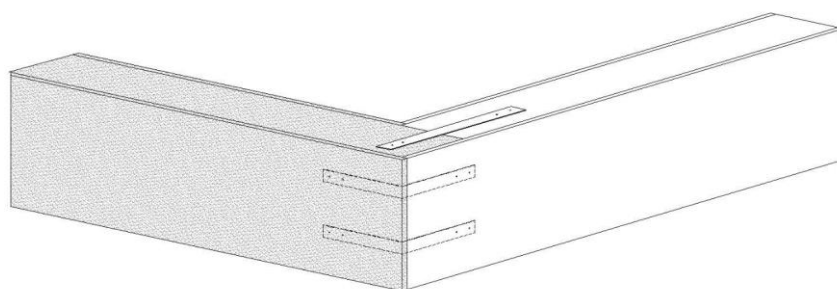
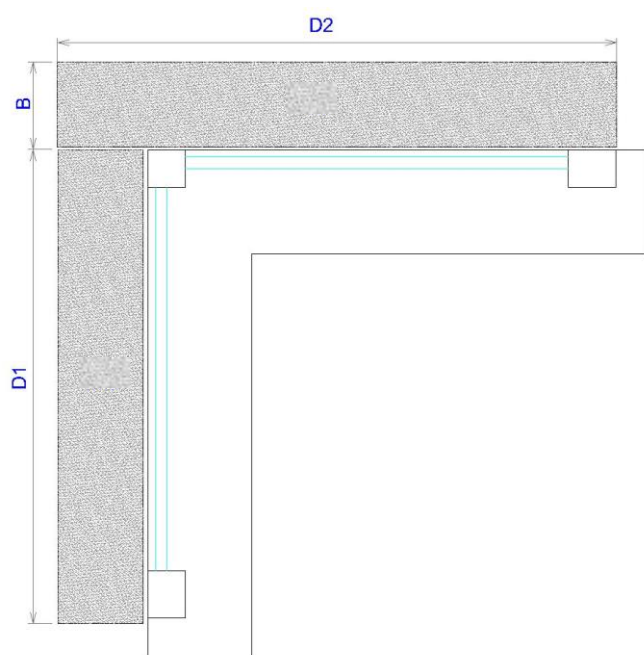

## 2. MOUNTING

Only skilled worker may do the mounting!

Construction preparation for mounting: fixed windows.

CHECK:

- We strongly recommend checking all delivered components before mounting process so you avoid possible troubles. Please contact the producer in case of components absence or other issues related to the blind mounting.

MOUNTING TOOLS:

1. Measure tape
2. Spirit level
3. Pen
4. Hammer
5. Electric drill and borer according to the surface for fixing
6. Battery drill
7. Magnetic extension
8. Bits PZ2, PH2, magnetic extension with hexagonal head 8 and 10
9. Fastener diameter 10, screw 5x60 mm
10. Purenit screw 4 x 15 mm
11. Screw for rail 3 x 15 mm

STANDARD MOUNTING PROCESS:

1. Mount the U profile onto window frame
2. Lay the purenit box on U mounting profile and put it into vertical line using spirit level.
3. Fix the box with mounting brackets
4. Check the box level with spirit level

Recommendation:

It is necessary to apply some penetration on the box before plaster application.

Contact person for technical questions: Milan Horský +420 777 262 812